



# Playground Options for POA

Karl Chalupa / Kevin Sullivan

# Agenda

Scope statement – what are trying to accomplish

Playground Equipment list

Review of potential playground sites

- Existing playground site
- Playground Site near Windemere Gate

Advantages / disadvantages to each site

Timeline - General Expectations

Cost implications

# Scope Statement

The new playground equipment will occupy **either** the existing playground site formerly occupied by the old playscape equipment or a new playground site near the weir near the Windemere gate. Both sites are inside the current park area.

The new playground equipment layout is significantly larger than the old playscape equipment. Both sites are being evaluated equipment fit and potential safety concerns.

# Playground Equipment List

## Included:

- Club Fun House – tall playscape with many climbing activities. 7 foot slide is included.
- 2 Bay swing set – using standard belt seats
- Teeter Totter – 2 seater with spring for up / down motion
- Free Play Sit and Spin –
- Bike rack for playground
- Fortress of Activity - TBD
- Picnic Table

# Playground Equipment List

## Not included in playground:

- Single station country skier
- Pull and Dip station
- Sit up Bench
- Basketball Backboard and post
- 2 – bike rack

# Existing Playground site

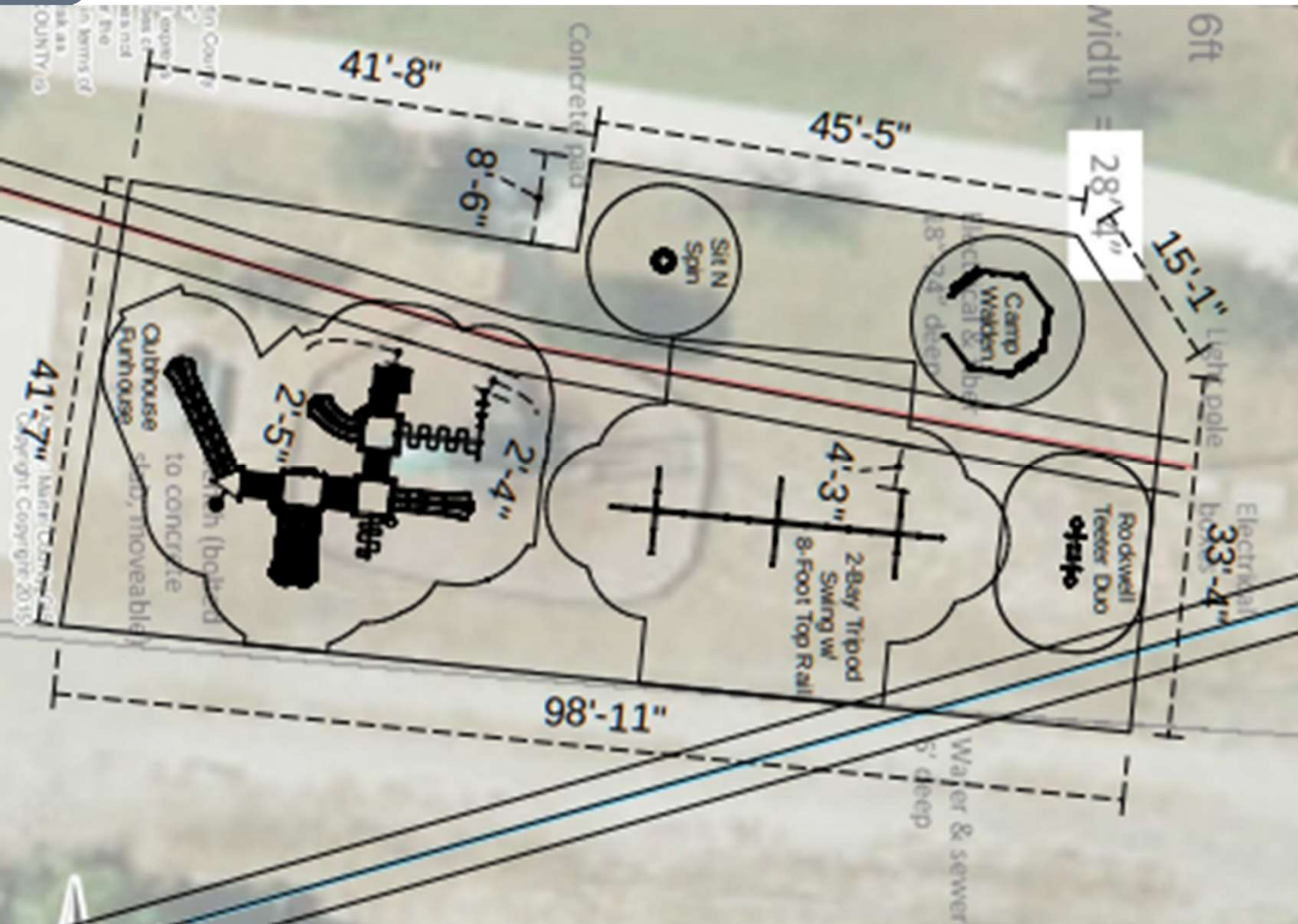

# Advantages to existing site

- Existing site does not need to be developed.
- Plantings – Existing trees / bushes will remain at the existing site. Some trees branches will need to be trimmed.

# Disadvantages to existing site

- Safety – Existing site abuts gravel road used by golf carts and E bikes. Golf carts and E bikes could be a safety concern. Playground area should be a fenced area.
- Resident concerns – Existing site is visible to Dalea residents.
- Existing site is a tight fit for a larger playground equipment.



Find MC Addresses



Site : 30 - 35 ft x 180ft

Weir

Road

# Proposed - Playground Site at Windemere Gate

Black lines are MC water boundaries

Windemere Gate





# New site near Windemere Gate

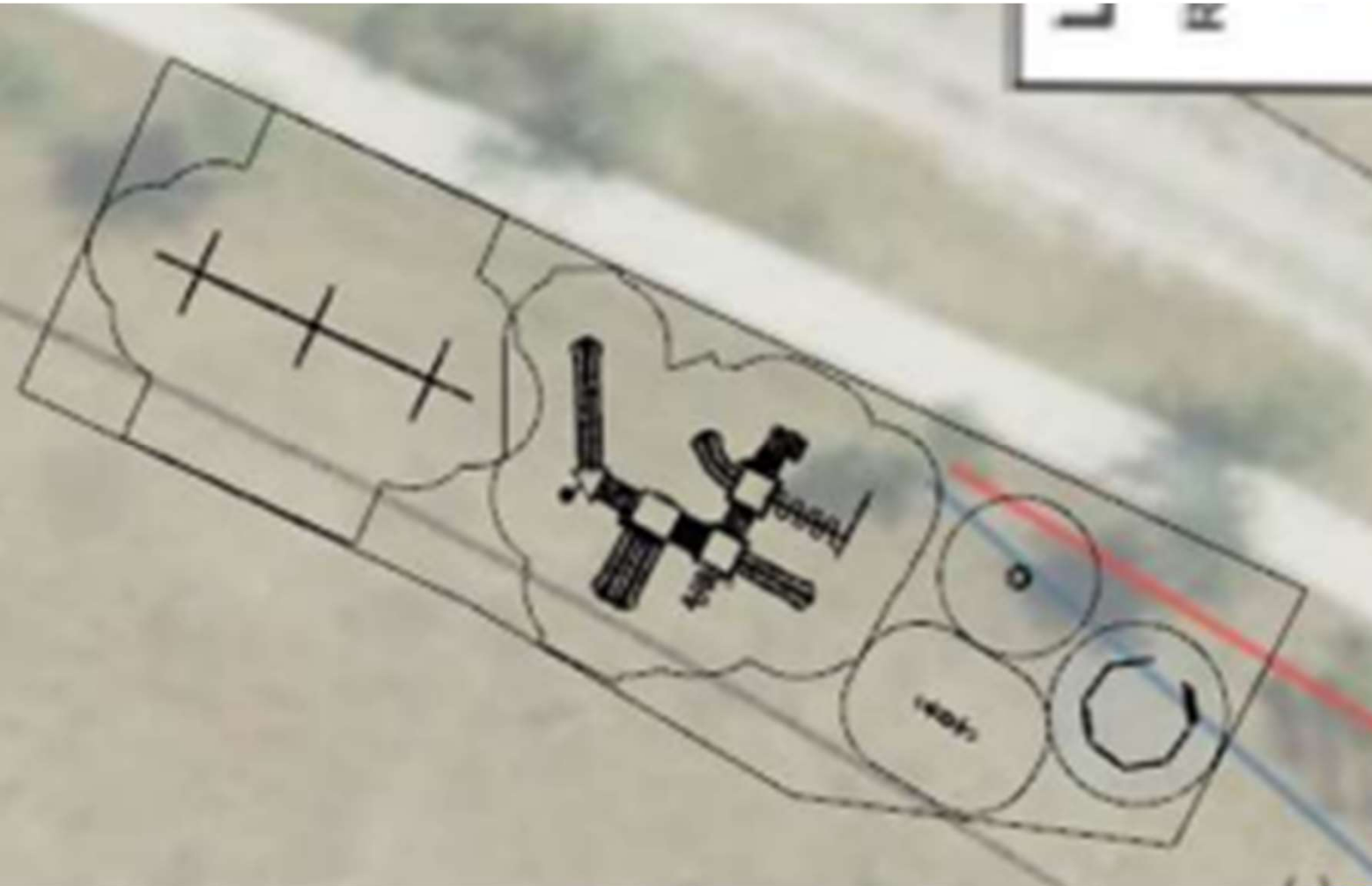

# Advantages to new site

- New site is generally a flat site that will abut MC water boundaries. This playground equipment will not infringe into the water collection area where the weir resides.
- Plantings – Existing trees / bushes will remain at this new site. Some trees branches at the new site will be trimmed.
- Safety - New site does not abut gravel road used by golf carts and E bikes. Golf carts and E bikes should not be a safety concern at Windemere site.
- Resident concerns – Windemere site is generally not visible to Windemere residents. For Windemere resident concerns – the new site is blocked by savanna plantings and pond from Windemere houses.
- Utilities at the new site are electric (lights) and fiber optic cable. 811 confirms that all the utilities are accounted for.

# Advantages to new site

- New site will provide more space for layout of playground equipment, picnic table and benches.
- The existing basketball court will remain as is in present location.

# Time Line – General Expectations

- Engage with 811 for utilities – electric / fiber / water - complete
- Updated Layouts from AAA with 811 information - complete
- Hard inventory of all existing components - complete
- Engage with local installation contractor - TBD
  - Permit review with City of Stuart / Martin County Water
  - Expected cost - \$18K to 21K
- Site decision with contractor input
- Installation
- Grand Opening

# Cost Implications

## Cost Adders

- Added fill to level off existing playground site - TBD
- 4 foot fence with a latched gate for keeping kids in play area and potential problems out of area. - TBD
- Add security camera system - TBD

**Thank you**

